

SPECIFICATIONS

Quality Lighting™

HOUSING Design NW-II is available in two sizes, with 13" or 18" width. The fixture can accommodate 70-200W MH, 35-150W HPS and 18W LPS lamps (Size 13) or 250 - 400W MH, and 250 - 400W HPS lamps (Size 18). The housings are one-piece heavy gauge die-cast aluminum. The lens frame is hinged and secured to the back box with two stainless steel screws (optional tamperproof screws available . . . specify Option TPS). Both sizes are C-UL & UL listed, "suitable for wet locations."

LENS A borosilicate prismatic tempered glass lens/diffuser is provided as standard.

OPTICAL SYSTEM The reflector system consists of a one-piece stippled asymmetric anodized reflector. The specially-engineered reflector system provides precise beam control at up to 79% efficiency.

INSTALLATION Both NW-II luminaires are surface wall-mount type and mount directly over a standard 4" outlet box, or will accept a surface conduit.

BALLAST All ballasts are CWA or HXHPF type, with power factor of 90%.

FINISH Polyester powder coat, electrostatically applied, which is preceded by a five step pre-treatment process including an iron phosphate priming stage for superior coating adhesion. This process meets or exceeds all ASTM testing requirements, including those for 1,000 - hour salt spray endurance testing.

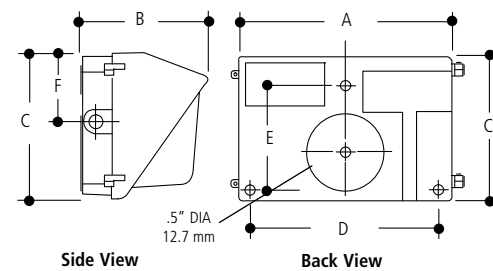

NW-II-13

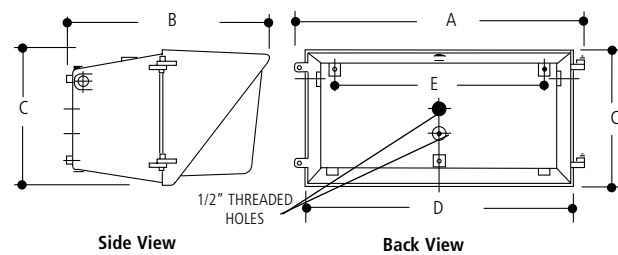

NW-II-18

DIMENSIONS		
	NW-II-13	NW-II-18
A	13.00" (330 mm)	18.00" (450 mm)
B	7.25" (164 mm)	12.75" (323.85 mm)
C	9.00" (228.6 mm)	9.00" (228.6 mm)
D	11.43" (290.32 mm)	17.00" (431.8 mm)
E	6.75" (171.4 mm)	12.18" (309 mm)
F	4.00" (101.6 mm)	N/A

WEIGHT	
13"	13 lbs. (5.90 kgs)
18"	34 lbs. (15.45 kgs)

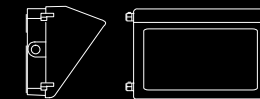

GARAGE & BUILDING MOUNTED

Quality Lighting™

Quality Lighting is a Philips group brand

2930 South Fairview Street
 Santa Ana, CA 92704
 Phone (714) 371-2394 • FAX (714) 668-1107
 Toll Free Phone (800) 545-1326
 e-mail: sales@qualitylighting.com • www.qualitylighting.com
 Specifications subject to change without notice. ©2007 Quality Lighting

DESIGN-NW-II-13/18



DISTRIBUTIONS

TYPE III Asymmetrical (Horiz. Lamp)

ORDERING EXAMPLE NW-II-13-3-HPS-150-DB-FD

DESIGN	DISTRIBUTION	HPS	MH = Std. Metal Halide MHP = Pulse Start		LAMP
			MH/MHP	LPS	
NW-II-13	3	50/70/100	70/100/175/200*		ED-17
	3	150			ED-17
	3			18	T-17
NW-II-18	3	250			ED-18
	3	400			ED-18
			250/400		ED-28/BT-37

*Available only in Pulse Start 50,70,100,200 MHP = Pulse Start

Note: Normal power factor ballast is available only in High Pressure Sodium 120V.

REQUIRED CHOICES

VOLTAGES	FINISH						
120	BK Black	WH White	GR Green	FG Gray	DB Bronze	SL Silver	CC Custom
208							Supply Color Chip
240							
277							
347							

OPTIONAL CHOICES

ELECTRICAL OPTIONS		OPTICAL OPTIONS		HOUSING OPTIONS	
FD	Single Fusing 120V/277V	WG	Stainless Steel Wire Guard	TPS	Tamperproof Screws
FDFD	Double Fusing 208V/240V			TPT	Tool For Tamperproof Screws
FDC	Single Fusing 347V				
PCB	Photo Control Button				