

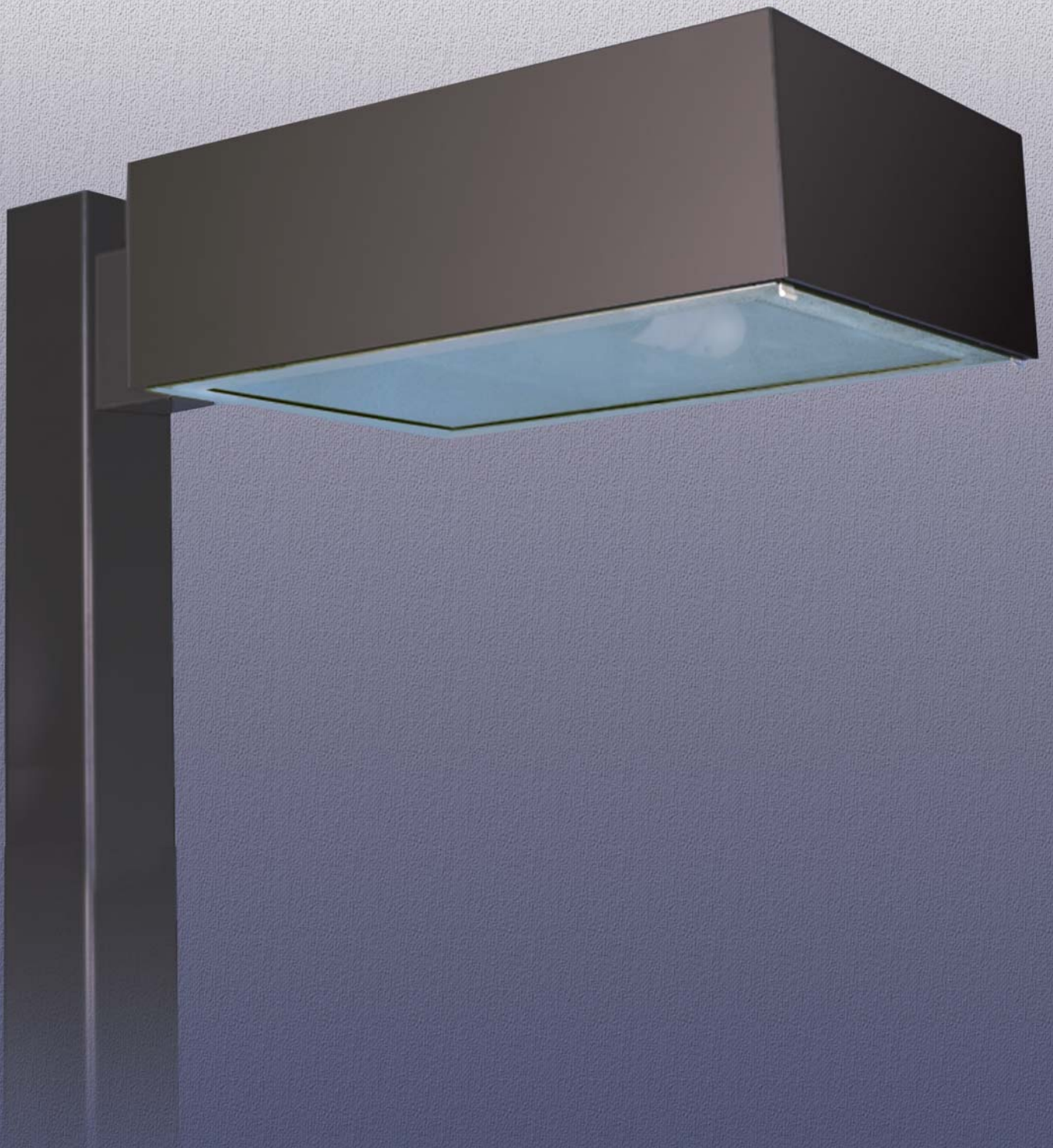



Quality Lighting™

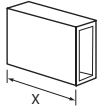

AREA & ROADWAY

SJX Series

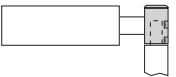

SERIES / SOURCE / WATTAGE	DISTRIBUTION	VOLTAGE	MOUNTING	OPTIONS	FINISH
Pulse Start Metal Halide (21") <input type="checkbox"/> SJX21P-150 <input type="checkbox"/> SJX21P-250	<input type="checkbox"/> 2 Type II asymmetric	<input type="checkbox"/> 120 <input type="checkbox"/> 208	<input type="checkbox"/> S 7" Arm Mount to Straight Square Pole (standard) Suitable for 1@90, 2@180. May also be used for mounting to round poles: 2@120 or 3@120 (with RPA accessory). 	<input type="checkbox"/> F1 Single Fusing, 120V/277V/347V <input type="checkbox"/> F2 Double Fusing, 208V/240V/480V <input type="checkbox"/> CSR Quartz Restrike Limited availability above 450W <input type="checkbox"/> TLR-PC Twist-Lock Receptacle with Photo Control Voltage must be specified. Not available in 347V or 480V.	<input type="checkbox"/> DB Dark Bronze <input type="checkbox"/> BLK Black <input type="checkbox"/> TBK Textured Black <input type="checkbox"/> SA Satin Aluminum <input type="checkbox"/> GR Gray <input type="checkbox"/> WHT White <input type="checkbox"/> RAL(*) Specify Custom RAL color number
High Pressure Sodium (21") <input type="checkbox"/> SJX21S-150 <input type="checkbox"/> SJX21S-250					
Pulse Start Metal Halide (27") <input type="checkbox"/> SJX27P-150 <input type="checkbox"/> SJX27P-250 <input type="checkbox"/> SJX27P-400	<input type="checkbox"/> FT Forward Throw (Type IV)	<input type="checkbox"/> 277 <input type="checkbox"/> 347	<input type="checkbox"/> S11 11" Arm Mount to Straight Square Pole, for mounting at 90° Required for 2@90, 3@90 and 4@90 mounting configurations.	<input type="checkbox"/> AL-SJX21 Auxiliary Polycarbonate Lens for SJX21 units <input type="checkbox"/> AL-SJX27 Auxiliary Polycarbonate Lens for SJX27 units 	
High Pressure Sodium (27") <input type="checkbox"/> SJX27S-150 <input type="checkbox"/> SJX27S-250 <input type="checkbox"/> SJX27S-400	<input type="checkbox"/> 5 Type 5 (Square)	<input type="checkbox"/> 480 <input type="checkbox"/> QV			
Pulse Start Metal Halide (31") <input type="checkbox"/> SJX31P-750 <input type="checkbox"/> SJX31P-875 <input type="checkbox"/> SJX31P-1000			<input type="checkbox"/> M Fixed Mastfitter Suitable for square poles. Allows mounting of standard arm to 2-3/8" OD x 4-5/8" vertical pole top tenon. 	<input type="checkbox"/> HSS House Side Shield 	
High Pressure Sodium (31") <input type="checkbox"/> SJX31S-750 <input type="checkbox"/> SJX31S-1000					
Metal Halide (31") <input type="checkbox"/> SJX31M-1000					

SJX21 21" housing					SJX27 27" housing					SJX31 31" housing							
source	wattage	distribution / lamp			source	wattage	distribution / lamp			source	wattage	distribution / lamp					
		2	3	FT	5			2	3	FT	5			2	3	FT	5
PSMH	150	ED28	ED28	BT28	NA	PSMH	150	NA	NA	NA	ED28	PSMH	750	NA	NA	ED/BT37	NA
HPS	150	E23½	E23½	E23½	NA	HPS	150	NA	NA	NA	E23½	HPS	750	NA	ED/BT37	ED/BT37	NA
PSMH	250	ED28	ED28	ED18	NA	PSMH	250	NA	NA	NA	ED28	PSMH	875	NA	ED/BT37	ED/BT37	NA
HPS	250	E18	E18	E18	NA	HPS	250	NA	NA	NA	ED28	PSMH	1000	NA	ED/BT37	ED/BT37	NA
						PSMH	400	ED/BT37	ED/BT37	ED28	ED28	MH	1000	NA	BT56	ED/BT37	NA
						HPS	400	E18	E18	E18	E18	HPS	1000	NA	E25	E25	NA

ACCESSORIES

Round and Square pole tenon adaptors mount to poles with 2-3/8" OD x 4 1/2" pole top tenon.

RPA-SJX Round Pole Adapter
 For mounting to 4" OD round poles. Required for each luminaire mounted with RPTA accessory.

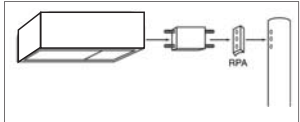

- RPTA-190-SJX Round Pole Tenon Adapter, 1@90
- RPTA-290-SJX Round Pole Tenon Adapter, 2@90
- RPTA-2120-SJX Round Pole Tenon Adapter, 2@120
- RPTA-390-SJX Round Pole Tenon Adapter, 3@90
- RPTA-3120-SJX Round Pole Tenon Adapter, 3@120
- RPTA-490-SJX Round Pole Tenon Adapter, 4@90

- SPTA-190-SJX Square Pole Tenon Adapter, 1@90
- SPTA-290-SJX Square Pole Tenon Adapter, 2@90
- SPTA-390-SJX Square Pole Tenon Adapter, 3@90
- SPTA-490-SJX Square Pole Tenon Adapter, 4@90

SW-SJX Wall Mount Bracket

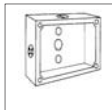

SPECIFICATIONS



- HOUSING** Each SJX housing shall be constructed from a one-piece extruded aluminum side and formed aluminum top plate. The fixture shall be UL listed "suitable for wet locations." Constructed to IP54.
- LENS FRAME** The extruded, natural anodized aluminum lens frame swings down for easy lamp access. Opposing spring-loaded latches allow tool-less lamp access.
- LENS AND GASKETING** The flat, thermal and shock resistant glass lens shall be mechanically secured to the lens frame. A one-piece extruded silicone gasket ensures a sealed enclosure.
- MOUNTING** Standard surface arm (field installed) shall be heavy gauge extruded aluminum, 7" long (11" long when fixtures are mounted at 90°). Threaded tension rods shall be used to bolt to 4" and larger straight square poles. Adapter required with round poles.
- REFLECTOR** SJX luminaires are horizontally lamped and available with the following distributions: 2 (Type II) - asymmetric; 3 (Type III) - asymmetric; FT - Forward throw (Type IV) with internal house side shield; 5 (Type V) - square. A11 Reflectors are field-rotatable and exchangeable.
- BALLAST** CWA and HX-HPF ballasts (+10% to 10% lamp power regulation) shall be rated for operation down to -20° F (MH), -30° F (PSMH), and -40° F (HPS). HX-HPF ballasts required with 150 watt units.
- FINISH** Polyester powder coat, electrostatically applied, which is preceded by a five step pre-treatment process including an iron phosphate priming stage for superior coating adhesion. This process meets or exceeds all ASTM testing requirements, including those for 1,000 - hour salt spray endurance testing.
- WARRANTY** Mechanical, finish and electrical shall be covered by a limited 1-year warranty. See terms and conditions for details.



Some luminaires use fluorescent or high intensity discharge (HID) lamps that contain small amounts of mercury. Such lamps are labeled 'Contain Mercury' and/or with the symbol 'Hg'. Lamps that contain mercury must be disposed of in accordance with local requirements. Information regarding lamp recycle and disposal can be found at www.lamprecycle.org.

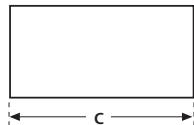
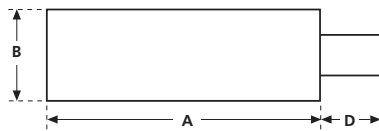

	21"	27"	31"
A	21.0" (53.34 cm)	27.0" (68.58 cm)	31.0" (78.74 cm)
B	6.6" (16.81 cm)	6.6" (16.81 cm)	11.4" (28.87 cm)
C	15.0" (38.10 cm)	20.0" (50.80 cm)	24.0" (60.96 cm)
D	7.0" (17.78 cm)	7.0" (17.78 cm)	7.0" (17.78 cm)

EFFECTIVE PROJECTED AREA (EPA) in square feet														
21"					27"					31"				
1@90	2@90	2@180	3@120	4@90	1@90	2@90	2@180	3@120	4@90	1@90	2@90	2@180	3@120	4@90
1.6	2.3	3.2	3.3	3.9	1.8	2.8	3.6	4.2	4.6	3.5	5.7	7.0	8.5	9.2

WEIGHT	21"	27"	31"
	57 lbs.	60 lbs.	62 lbs.

DRILL TEMPLATE

DT4-SJX
not to scale

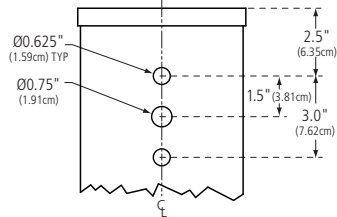

Drill Template **DT4-SJX**
Standard Arm Mount:

S or **S11** to 4" - 6" Square Pole
Requires RPA-SJX to mount to 4" - 5" Round Pole.
Also used with Wall Mount Bracket and Tenon Mounting Adapters.

Quality Lighting™

Quality Lighting is a Philips group brand

1611 Clovis Barker Road
San Marcos, Texas 78640
Toll Free Phone (800) 545-1326
FAX (866) 713-6002
www.qualitylighting.com
e-mail: Quality.Info@Philips.com

Quality Lighting reserves the right to change specifications and dimensions without notice. Lamp and electrical specifications / availability subject to change by manufacturer without notice. ©2009 Philips Group

PT#: QLBR0101B0909