

## SPECIFICATIONS

*Quality Lighting™*

**HOUSING** The one piece reinforced housing is constructed of heavy gauge spun aluminum. The fixture is C-UL & UL listed "suitable for wet locations".

**LENS FRAME** The heavy-duty cast aluminum lens frame shall be hinged to the housing with twin stainless steel hinges.

**LENS** The flat or convex thermal and shock resistant glass lens is sealed to the lens frame and secured with retainer clips.

**LENS AND GASKETING** The lens is gasketed to the lens frame with extruded butyl acrylic tape sealant. The lens frame is gasketed to the housing's internal reinforcing ring with silicone-impregnated Dacron gasketing.

**INSTALLATION** Design 134 fixtures are supplied with a yoke assembly allowing the fixture to be tilted 45° to permit easy access to the reflector compartment for re-lamping, or to the ballast compartment for service. Tenon adapter brackets (TPH) are available for mounting to poles with existing tenons.

**REFLECTOR** Design 134 shall be available with the following reflector systems: 1) Type VR - rectangular distribution; 2) Type F - forward throw distribution; 3) Type V - symmetrical distribution; 4) Type 3 - asymmetrical distribution; 5) Type VS - square vertical lamp. All photometric data shall be certified by an independent testing facility.

**BALLAST** All ballasts are CWA or HXHPF type with power factor of 90% and are tray mounted and supplied with quick disconnects. Ballasts are rated for 20°F or 40°F operation.

**FINISH** Polyester powder coat, electrostatically applied, which is preceded by a five step pre-treatment process including an iron phosphate priming stage for superior coating adhesion. This process meets or exceeds all ASTM testing requirements, including those for 1,000 - hour salt spray endurance testing.

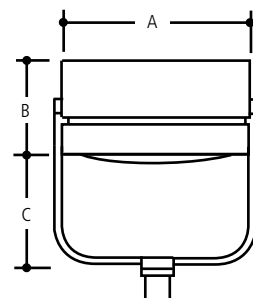

### DIMENSIONS

	20"	25"
A	20.00" dia. (508 mm)	25.00" dia. (635 mm)
B	10.50" (266.7 mm)	11.00" (279.4 mm)
C	12.75" (323.8 mm)	14.50" (368 mm)

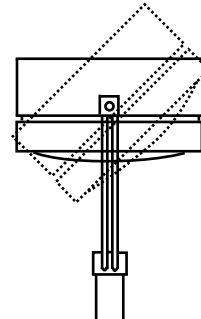

### EFFECTIVE PROJECTED AREA (EPA)

20"	25"
1.40 sq. ft. (.13M2)	2.0 sq. ft. (.18M2)

### WEIGHT

20"	25"
34 lbs. (15.4 kgs)	59 lbs. (26.7 kgs)

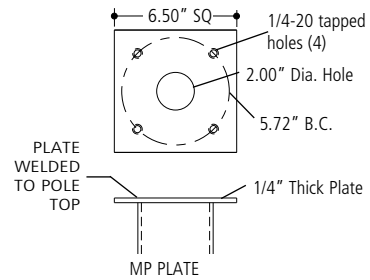

### MP PLATE NOTES

Provide plate as shown above or purchase plate from QL.  
On existing poles with 2" tenon - use TPH adapter.

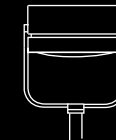

AREA & ROADWAY

*Quality Lighting™*

Quality Lighting is a Philips group brand

2930 South Fairview Street  
Santa Ana, CA 92704  
Phone (714) 371-2394 • FAX (714) 668-1107  
Toll Free Phone (800) 545-1326  
e-mail: sales@qualitylighting.com • www.qualitylighting.com  
Specifications subject to change without notice. ©2007 Quality Lighting

DESIGN-134/20/25



#### DISTRIBUTIONS

TYPE VR Rectangular Symmetrical (Vert. Lamp)  
 TYPE VS Square (Vert. Lamp)  
 TYPE V Symmetrical (Vert. Lamp)  
 TYPE 3 Asymmetrical (Horiz. Lamp)  
 TYPE F Forward Throw (Horiz. Lamp)

#### ORDERING EXAMPLE 134-25-VR-HPS-400-CL-DB-120-MP-FD-CL80x360

DESIGN	DISTRIBUTION	HPS	MH = Std. Metal Halide MHP = Pulse Start	LAMP	CL = Convex glass lens FL = Flat glass lens
			MH/MHP		LENS
134-20	3	70/100/150	100/150/175/200*	ED-17	FL
	F	70/100/150	100/150/175/200*	ED-17	FL
	V	70/100/150	100/150/175/200*	ED-17	FL
134-25	VR	250/400		ED-18	CL or FL
	VR		250/400	ED-28	CL or FL
	VR		400/450*	ED-37	CL
	VR	750		BT-37	CL
134-25	VS	250/400		ED-18	CL or FL
	VS		250/400	ED-28	CL or FL
	VS		400/450*	ED-37	CL
	VS	750		BT-37	CL
134-25	3	250/400		ED-18	FL
	3		250	ED-28	FL
	3		400	ED-37	FL
	3	750		BT-37	FL
134-25	F	250/400		ED-18	FL
	F		250	ED-28	FL
	F		400	ED-37	FL
	F	750		BT-37	FL

\* Available only in Pulse Start 100,150,200,450 MHP = Pulse Start

#### REQUIRED CHOICES

##### FINISH



##### VOLTAGES MOUNTINGS

120	TPH	Tenon Adapter plate
208		(Slipfits 2-3/8" to 2-7/8" Pipe Tenon)
240	MP	Mounting Plate
277		(Weld to pole) See detail.
347		
480		

#### OPTIONAL CHOICES

ELECTRICAL OPTIONS		OPTICAL OPTIONS		LIGHT TRESPASS OPTIONS	
FD	Single Fusing 120V/277V	LX	Vandal Resistant Lens	CL80x360	Internal 80° Vert. x 360° Horiz. Lens Shielding
FDD	Double Fusing 480V		(Lexan lens 400 W max)	CL60x135	Internal 60° Vert. x 135° Horiz. Lens Shielding
FDFD	Double Fusing 208V/240V			HSS	House Side Shield (75° Standard) (External)
FDC	Single Fusing 347V			FL	Flat clear glass lens (see ordering information for availability)
PCT	Photo Cell and Receptacle				



TPH



CL80x360 - Internal  
80° Vert. x 360°  
Horiz. Lens Shielding



CL60x135 - Internal  
60° Vert. x 135° Horiz.  
Lens Shielding