

Parking Areas
Building Entrances
Pedestrian Walkways
Shopping Malls
Large Areas



Specifications



- HOUSING** Each Design 130 domed top, one-piece, reinforced housing shall be constructed of heavy-gauge spun aluminum. There shall be no seams, weld beads or other visible disturbances to the housing's smooth surface. All internal and external threaded hardware shall be stainless steel. The fixture shall be UL listed "suitable for wet locations".
- LENS FRAME** The heavy-duty cast aluminum lens frame shall be hinged to the housing with twin stainless steel piano hinges and secured with flush mounted, vibration resistant, captive screw type fasteners. The housing and lens frame assembly shall be equipped with a positive locking support providing "tilt away housing" access to the optical and ballast compartments for servicing.
- LENS** Lens: The flat or convex thermal and shock resistant glass lens shall be sealed to the lens frame and secured with retainer clips.
- DUAL GASKETING** The lens shall be gasketed to the lens frame with extruded butyl acrylic tape sealant. The lens frame shall be gasketed to the housing's internal reinforcement ring with silicone impregnated Dacron gasketing.
- INSTALLATION** Each Design 130's lens frame assembly shall be welded to an extruded aluminum spider type mounting assembly and a cast aluminum slipfitter. The assembly shall slipfit a 2.375" O.D. x 4.5" tenon. The prewired mounting assembly's cast aluminum post-top fitter shall have a removable top cap allowing the installer to complete power supply wiring after the luminaire has been set atop its pole.
- REFLECTOR SYSTEM** Design 130 shall be available with the following reflector systems: 1) Type VR - rectangular distribution; 2) Type F - forward throw distribution; 3) Type V - symmetrical distribution; 4) Type 3 - asymmetrical distribution; 5) Type VS - square vertical lamp. All photometric data shall be certified by an independent testing facility.
- BALLAST** All CWA ballasts (+10% to -10% lamp power regulation) shall be tray mounted and supplied with quick-disconnects. Ballasts are rated for -20° F operation. All non CWA ballast shall be HPPF.
- FINISH** Polyester powder coat, electrostatically applied, which is preceded by a five step pre-treatment process including an iron phosphate priming stage for superior coating adhesion. This process meets or exceeds all ASTM testing requirements, including those for 1,000 - hour salt spray endurance testing.

PROJECT
FIXTURE TYPE
CATALOG#

Quality Lighting
 2930 South Fairview Street
 Santa Ana, CA 92704
 Phone (714) 371-2394 • FAX (714) 668-1107 • Toll Free Phone (800) 545-1326
 e-mail: sales@qualitylighting.com • www.qualitylighting.com
 Specifications subject to change without notice. ©2007 Quality Lighting

DISTRIBUTIONS

TYPE VS Square (Vert. Lamp) TYPE 3 Asymmetrical (Horiz. Lamp)
 TYPE VR Rectangular (Vert. Lamp) TYPE V Symmetrical (Vert. Lamp)
 TYPE F Forward Throw (Horiz. Lamp)

ORDERING EXAMPLE 129-25-VR-HPS-400-CL-DB-120-FD-CL80x360

DESIGN	DISTRIBUTION	HPS	H/MHP	LAMP	LENS
130-20	3	70/100/150	70/100/150/175/200*	ED-17	FL
	V	70/100/150	70/100/150/175/200*	ED-17	FL
	F	70/100/150	70/100/150/175/200*	ED-17	FL
130-25	VR/VS	250/400		ED-18	CL or FL
	VR/VS		250/400	ED-28	CL or FL
	VR/VS		400/450*	ED-37	CL or FL
	VR/VS	750		BT-37	CL or FL
	3/F	250/400		ED-18	FL
	3/F	750	250/400	ED-28/37	FL
130-29	VR/VS	400		ED-18	CL or FL
	VR/VS	750		BT-37	CL or FL
	VR/VS	1000		E-25	CL
	VR/VS	1000 Flat Lens		ED-37	FL
	VR/VS		400	ED-37	CL or FL
	VR/VS		1000	BT-56	CL
130-29	3/F	400		ED-18	FL
	3/F	750		BT-37	FL
	3/F	1000		E-25	FL
	3/F		400	ED-37	FL
	3/F		1000	BT-37	FL

* Available only in Pulse Start 100,150,200,450 MHP = Pulse Start

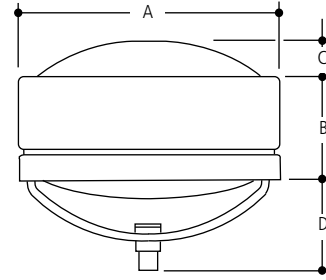

Design 130-29

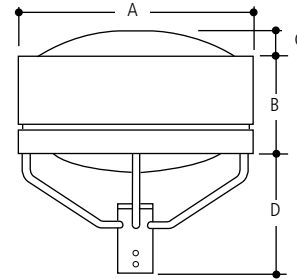

Design 130-20/25

EFFECTIVE PROJECTED AREA (EPA)

20"	25"	29"
1.60 sq. ft. (.15M2)	2.20 sq. ft. (.21M2)	2.86 sq. ft. (.27M2)

WEIGHT

20"	25"	29"
40 lbs. (18.8 kgs)	63 lbs. (28.6 kgs)	79 lbs. (35.9 kgs)

DIMENSIONS

	20"	25"	29"
A	20.00" dia. (508 mm)	25.00" dia. (635 mm)	29.00" dia. (736.6 mm)
B	10.50" (280 mm)	10.00" (254 mm)	10.00" (254 mm)
C	3.25" (82 mm)	3.50" (89 mm)	4.70" (119 mm)
D	10.5" (266.7 mm)	11.7" (297.18 mm)	12.0" (304.8 mm)

REQUIRED CHOICES

FINISH



VOLTAGES

- 120
- 208
- 240
- 277
- 347
- 480

OPTIONAL CHOICES

ELECTRICAL OPTIONS

- FD Single Fusing 120V/277V
- FDD Double Fusing 480V
- DFDD Double Fusing 208V/240V
- FDC Single Fusing 347V
- PCT Photo Cell and Receptacle

OPTICAL OPTIONS

- LX Vandal Resistant Shield (20" & 25" only, 400 Max)

LIGHT TRESPASS OPTIONS

- CL80x360 Internal 80° Vert. x 360° Horiz. Lens Shielding
- CL60x135 Internal 60° Vert. x 135° Horiz.-Lens Shielding
- HSS House Side Shield (75° Standard) (External)
- FL Flat clear glass lens (see ordering information for availability)



CL80x360 - Internal 80° Vert. x 360° Horiz. Lens Shielding



CL60x135 - Internal 60° Vert. x 135° Horiz. Lens Shielding