

## SPECIFICATIONS

*Quality Lighting™*

- HOUSING** Each Design 130 domed top, one-piece, reinforced housing shall be constructed of heavy-gauge spun aluminum. There shall be no seams, weld beads or other visible disturbances to the housing's smooth surface. All internal and external threaded hardware shall be stainless steel. The fixture shall be UL listed "suitable for wet locations".
- LENS FRAME** The heavy-duty cast aluminum lens frame shall be hinged to the housing with twin stainless steel piano hinges and secured with flush mounted, vibration resistant, captive screw type fasteners. The housing and lens frame assembly shall be equipped with a positive locking support providing "tilt away housing" access to the optical and ballast compartments for servicing.
- LENS** Lens: The flat or convex thermal and shock resistant glass lens shall be sealed to the lens frame and secured with retainer clips.
- DUAL GASKETING** The lens shall be gasketed to the lens frame with extruded butyl acrylic tape sealant. The lens frame shall be gasketed to the housing's internal reinforcement ring with silicone impregnated Dacron gasketing.
- INSTALLATION** Each Design 130's lens frame assembly shall be welded to an extruded aluminum spider type mounting assembly and a cast aluminum slip-fitter. The assembly shall slipfit a 2.375" O.D. x 4.5" tenon. The prewired mounting assembly's cast aluminum post-top fitter shall have a removable top cap allowing the installer to complete power supply wiring after the luminaire has been set atop its pole.
- REFLECTOR SYSTEM** Design 130 shall be available with the following reflector systems: 1) Type VR - rectangular distribution; 2) Type F - forward throw distribution; 3) Type V - symmetrical distribution; 4) Type 3 - asymmetrical distribution; 5) Type VS - square vertical lamp. All photometric data shall be certified by an independent testing facility.
- BALLAST** All CWA ballasts (+10% to -10% lamp power regulation) shall be tray mounted and supplied with quick-disconnects. Ballasts are rated for -20° F operation. All non CWA ballast shall be HPF.
- FINISH** Polyester powder coat, electrostatically applied, which is preceded by a five step pre-treatment process including an iron phosphate priming stage for superior coating adhesion. This process meets or exceeds all ASTM testing requirements, including those for 1,000 - hour salt spray endurance testing.

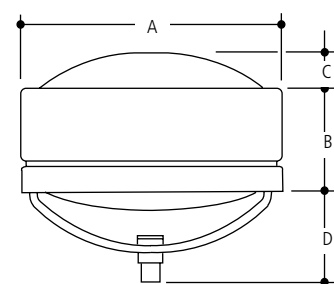

Design 130-29

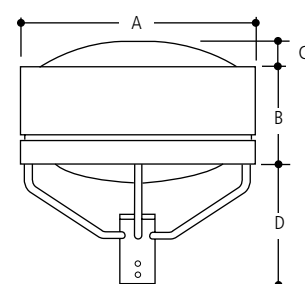

Design 130-20/25

DIMENSIONS	20"	25"	29"
	A	20.00" dia. (508 mm)	25.00" dia. (635 mm)
B	10.50" (280 mm)	10.00" (254 mm)	10.00" (254 mm)
C	3.25" (82 mm)	3.50" (89 mm)	4.70" (119 mm)
D	10.5" (266.7 mm)	11.7" (297.18 mm)	12.0" (304.8 mm)

EFFECTIVE PROJECTED AREA (EPA)		
20"	25"	29"
1.60 sq. ft. (.15M2)	2.20 sq. ft. (.21M2)	2.86 sq. ft. (.27M2)

WEIGHT		
20"	25"	29"
40 lbs. (18.8 kgs)	63 lbs. (28.6 kgs)	79 lbs. (35.9 kgs)

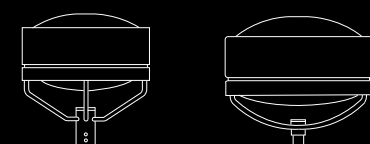

AREA & ROADWAY

*Quality Lighting™*

Quality Lighting is a Philips group brand

2930 South Fairview Street  
 Santa Ana, CA 92704  
 Phone (714) 371-2394 • FAX (714) 668-1107  
 Toll Free Phone (800) 545-1326  
 e-mail: sales@qualitylighting.com • www.qualitylighting.com  
 Specifications subject to change without notice. ©2007 Quality Lighting

**DESIGN-130/20/25/29**

